

Rack & Panel

100 Series

Removable Contacts

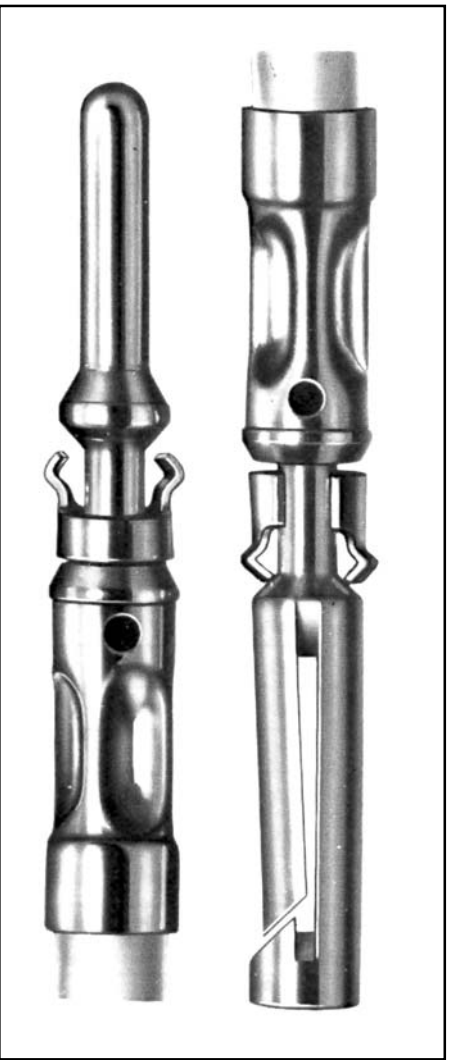

6x Actual Size — Typical Removable Contact

Winchester Electronics removable contacts allow quick, easy removal and replacement of any contact without disturbing another - and without discarding the connector. They offer exceptional flexibility in both the choice and revision of circuitry for rack and panel equipment ... at substantial savings in replacement and installation time. In addition, wiring costs are significantly lowered, as wires may be assembled away from the

connector itself. Assembly of contacts to wires is further simplified by crimp type contacts. A contact is slipped on the wire, inserted in the crimping tool, and crimped securely in place in seconds. Compact and self-aligning, these removable contacts provide high retention force and exceptional mechanical and electrical reliability. Solder type removable contacts are available for connectors using MRAC contacts.

SPECIFICATIONS

Pin Contacts:	Copper Alloy, gold plated.	Specifications:	Conforms to applicable portions of MIL-C-39029
Socket Contacts:	Closed entry type machined from copper alloy, gold plated.	Wire Sizes:	From a minimum 28 to a maximum 14 AWG. All contacts are designed to accept a minimum AWG conductor up to two sizes below maximum gage (each contact.)
Tools:	Complete line available. Includes automatic pneumatic, pneumatic hand operated, hand operated crimping tools, insertion and removal tools.	Termination Types:	Crimp, solder, dip solder or wire-wrap
Military		Current Rating:	7.5 Amps maximum for .040 contacts, 13 Amps maximum for .062 contacts.

To Order: Specify by catalog number

Note: Series 100 Removable Contacts are not supplied with the connector. They must be ordered as a separate item.

Winchester/Retconn

400 Park Road ■ Watertown, Connecticut 06795-0500 ■ Phone: (860) 945-5000 ■ FAX: (860) 945-5191 ■ Internet: <http://www.litton-weed.com>

100 SERIES CONTACTS

Loose Contact Part Number	Reeled Contact Part Number 2,000/Reel	Accommodates Conductor Sizes	Used In Connector Series	Diameter (See Drawings)		Mating Pin Diameter	Description of Contacts	See Figure Number	AMPS per Cont	For Loose Contacts			For Loose Contacts			For Reeled Contacts			
				A	B					Locator	Hand Tool	Pneumatic Tool	Gage Plug Part Number	Hand Tool Part Number	Positioner Part Number	Gage Plug Part Number	Pneumatic Tool Part Number	Depth Block Part Number	Gage Plug Part Number
				100-1014P	100-0909P					14-16	MRAC, TMRAC, XAC, TXAC	.081	.105	.062	Crimp Contact	1	13	107-0945	107-0903-2A
100-1014S	100-0919S	14-16	MRAC, TMRAC, XAC, TXAC	.081	.105	.062	Crimp Contact	2	13	107-0945	107-0903-2A	107-0918	5431-22	107-0970	107-0981	5431-17	107-0961	107-0966	5431-14
100-1016P	100-0911P	16-18-20	MRAC, TMRAC, XAC, TXAC	.067	.092	.062	Crimp Contact	1	13	107-0945	107-0903-2A	107-0918	5431-14	107-0970	107-0977	5431-11	107-0961	107-0966	5431-14
100-1016S	100-0921S	16-18-20	MRAC, TMRAC, XAC, TXAC	.067	.097	.062	Crimp Contact	2	13	107-0945	107-0903-2A	107-0918	5431-14	107-0970	107-0977	5431-11	107-0961	107-0966	5431-14
100-1018P	100-0913P	18-20-22	MRAC, TMRAC, XAC, TXAC	.052	.078	.062	Crimp Contact	1	13	107-0945	107-0903-2A	107-0918	5431-14	107-0970	107-0977	5431-11	107-0961	107-0966	5431-14
100-1018S	100-0923S	18-20-22	MRAC, TMRAC, XAC, TXAC	.052	.078	.062	Crimp Contact	2	13	107-0945	107-0903-2A	107-0918	5431-14	107-0970	107-0977	5431-11	107-0961	107-0966	5431-14
100-1020P	100-0915P	20-22-24	MRAC, TMRAC, XAC, TXAC	.045	.067	.062	Crimp Contact	1	13	107-0945	107-0903-2A	107-0918	5431-15	107-0970	107-0976	5431-12	107-0961	107-0965	5431-15
100-1020S	100-0925S	20-22-24	MRAC, TMRAC, XAC, TXAC	.045	.065	.062	Crimp Contact	2	13	107-0945	107-0903-2A	107-0918	5431-15	107-0970	107-0976	5431-12	107-0961	107-0965	5431-15
100-1022P	100-0907P	22-24-26	MRAC, TMRAC, XAC, TXAC	.033	.055	.062	Crimp Contact	1	13	107-0945	107-0903-2A	107-0918	5431-15	107-0970	107-0976	5431-12	107-0961	107-0965	5431-15
100-1022S	100-0908S	22-24-26	MRAC, TMRAC, XAC, TXAC	.033	.055	.062	Crimp Contact	2	13	107-0945	107-0903-2A	107-0918	5431-15	107-0970	107-0976	5431-12	107-0961	107-0965	5431-15
100-1024P	100-0917P	24-26-28	MRAC, TMRAC, XAC, TXAC	.027	.055	.062	Crimp Contact	1	13	107-0945	107-0903-2A	107-0918	5431-15	107-0970	107-0976	5431-12	107-0961	107-0965	5431-15
100-1024S	100-0927S	24-26-28	MRAC, TMRAC, XAC, TXAC	.027	.055	.062	Crimp Contact	2	13	107-0945	107-0903-2A	107-0918	5431-15	107-0970	107-0976	5431-12	107-0961	107-0965	5431-15
100-1026P	100-0963P	26-28-30	MRAC, TMRAC, XAC, TXAC	.024	.050	.062	Crimp Contact	1	13	107-0945	107-0903-2A	107-0918	5431-15	107-0970	107-0976	5431-12	107-0961	107-0965	5431-15
100-1026S	100-0965S	26-28-30	MRAC, TMRAC, XAC, TXAC	.024	.050	.062	Crimp Contact	2	13	107-0945	107-0903-2A	107-0918	5431-15	107-0970	107-0976	5431-12	107-0961	107-0965	5431-15
100-2016P	100-0949P	16-18-20	MRAC, TMRAC, XAC, TXAC	.067	.096	.040	Crimp Contact	3	7.5	107-0945	107-0903-2A	107-0918	5431-14	107-0970	107-0977	5431-11	107-0961	107-0966	5431-14
100-2016S	100-0939S	16-18-20	MRAC, TMRAC, XAC, TXAC	.067	.096	.040	Crimp Contact	4	7.5	107-0945	107-0903-2A	107-0918	5431-14	107-0970	107-0977	5431-11	107-0961	107-0966	5431-14
100-2018P	100-0943P	18-20-22	MRAC, TMRAC, XAC, TXAC	.052	.078	.040	Crimp Contact	3	7.5	107-0945	107-0903-2A	107-0918	5431-14	107-0970	107-0977	5431-11	107-0961	107-0966	5431-14
100-2018S	100-0933S	18-20-22	MRAC, TMRAC, XAC, TXAC	.052	.078	.040	Crimp Contact	4	7.5	107-0945	107-0903-2A	107-0918	5431-14	107-0970	107-0977	5431-11	107-0961	107-0966	5431-14
100-2020P	100-0945P	20-22-24	MRAC, TMRAC, XAC, TXAC	.045	.065	.040	Crimp Contact	3	7.5	107-0945	107-0903-2A	107-0918	5431-15	107-0970	107-0976	5431-12	107-0961	107-0965	5431-15
100-2020S	100-0935S	20-22-24	MRAC, TMRAC, XAC, TXAC	.045	.065	.040	Crimp Contact	4	7.5	107-0945	107-0903-2A	107-0918	5431-15	107-0970	107-0976	5431-12	107-0961	107-0965	5431-15
100-2022P	100-0947P	22-24-26	MRAC, TMRAC, XAC, TXAC	.033	.055	.040	Crimp Contact	3	7.5	107-0945	107-0903-2A	107-0918	5431-15	107-0970	107-0976	5431-12	107-0961	107-0965	5431-15
100-2022S	100-0937S	22-24-26	MRAC, TMRAC, XAC, TXAC	.033	.055	.040	Crimp Contact	4	7.5	107-0945	107-0903-2A	107-0918	5431-15	107-0970	107-0976	5431-12	107-0961	107-0965	5431-15
100-2024P	100-0951P	24-26-28	MRAC, TMRAC, XAC, TXAC	.027	.055	.040	Crimp Contact	3	7.5	107-0945	107-0903-2A	107-0918	5431-15	107-0970	107-0976	5431-12	107-0961	107-0965	5431-15
100-2024S	100-0941S	24-26-28	MRAC, TMRAC, XAC, TXAC	.027	.055	.040	Crimp Contact	4	7.5	107-0945	107-0903-2A	107-0918	5431-15	107-0970	107-0976	5431-12	107-0961	107-0965	5431-15

Continued on page RP / 85

100 SERIES CONTACTS

Loose Contact Part Number	Reeled Contact Part Number 2,000/Reel	Accommodates Conductor Sizes	Used In Connector Series	Diameter (See Drawings)		Mating Pin Diameter	Description of Contacts	See Figure Number	AMPS per Cont	For Loose Contacts				For Loose Contacts			For Reeled Contacts		
				A	B					Locator	Hand Tool	Pneumatic Tool	Gage Plug Part Number	Hand Tool Part Number	Positioner Part Number	Gage Plug Part Number	Pneumatic Tool Part Number	Depth Block Part Number	Gage Plug Part Number
				100-2514P	Not Available					14-16-18	MRAC, TMRAC XAC, TXAC	.081	.105	.062	Solder Contact	5	13	N/A Solder Contact	
100-2514S	Not Available	14-16-18	MRAC, TMRAC XAC, TXAC	.081	.105	.062	Solder Contact	6	13	N/A Solder Contact									
100-2516P	Not Available	16-18-20	MRAC, TMRAC XAC, TXAC	.067	.097	.062	Solder Contact	5	13	N/A Solder Contact									
100-2516S	Not Available	16-18-20	MRAC, TMRAC XAC, TXAC	.067	.097	.062	Solder Contact	6	13	N/A Solder Contact									
100-2518P	Not Available	18-20-22	MRAC, TMRAC XAC, TXAC	.052	.076	.062	Solder Contact	5	13	N/A Solder Contact									
100-2518S	Not Available	18-20-22	MRAC, TMRAC XAC, TXAC	.052	.076	.062	Solder Contact	6	13	N/A Solder Contact									
100-2520P	Not Available	20-22-24	MRAC, TMRAC XAC, TXAC	.045	.065	.062	Solder Contact	5	13	N/A Solder Contact									
100-2520S	Not Available	20-22-24	MRAC, TMRAC XAC, TXAC	.045	.065	.062	Solder Contact	6	13	N/A Solder Contact									
100-2522P	Not Available	22-24-26	MRAC, TMRAC XAC, TXAC	.033	.055	.062	Solder Contact	5	13	N/A Solder Contact									
100-2522S	Not Available	22-24-26	MRAC, TMRAC XAC, TXAC	.033	.055	.062	Solder Contact	6	13	N/A Solder Contact									
100-2524P	Not Available	24-26-28	MRAC, TMRAC XAC, TXAC	.027	.055	.062	Solder Contact	5	13	N/A Solder Contact									
100-2524S	Not Available	24-26-28	MRAC, TMRAC XAC, TXAC	.027	.055	.062	Solder Contact	6	13	N/A Solder Contact									
100-2616P	Not Available	16-18-20	MRAC, TMRAC XAC, TXAC	.067	.096	.040	Solder Contact	7	7.5	N/A Solder Contact									
100-2616S	Not Available	16-18-20	MRAC, TMRAC XAC, TXAC	.067	.096	.040	Solder Contact	8	7.5	N/A Solder Contact									
100-2620P	Not Available	20-22-24	MRAC, TMRAC XAC, TXAC	.045	.065	.040	Solder Contact	7	7.5	N/A Solder Contact									
100-2620S	Not Available	20-22-24	MRAC, TMRAC XAC, TXAC	.045	.065	.040	Solder Contact	8	7.5	N/A Solder Contact									
100-4020P	100-0801P	20-22	SREC, 42 Series	See Drawing		.030	Crimp Contact	23	5	107-43302	107-43300		5431-25				107-0961	107-0965	5431-15
100-4020S	100-0802S	20-22	SREC, 42 Series	See Drawing		.030	Crimp Contact	24	5	107-43302	107-43300		5431-25				107-0961	107-0965	5431-15
100-4024P	100-0805P	24-26-28	SREC, 42 Series	See Drawing		.030	Crimp Contact	25	5	107-43302	107-43300		5431-25				107-0961	107-0965	5431-15
100-4024S	100-0806S	24-26-28	SREC, 42 Series	See Drawing		.030	Crimp Contact	26	5	107-43302	107-43300		5431-25				107-0961	107-0965	5431-15
100-4028P	100-0809P	28-30	SREC, 42 Series	See Drawing		.030	Crimp Contact	27	5	107-43302	107-43300		5431-25				107-0961	107-0965	5431-15
100-4028S	100-0810S	28-30	SREC, 42 Series	See Drawing		.030	Crimp Contact	28	5	107-43302	107-43300		5431-25				107-0961	107-0965	5431-15
100-51014S	100-0981S	14-16	MRAC, TMRAC, XAC, TXAC	.081	.105	.062	3 Piece Crimp	19	13	107-0945	107-0903-2A	107-0918	5431-14				107-0961	107-0966	5431-14
100-51016S	100-0982S	16-18-20	MRAC, TMRAC, XAC, TXAC	.067	.094	.062	3 Piece Crimp	19	13	107-0945	107-0903-2A	107-0918	5431-14				107-0961	107-0966	5431-14
100-51018S	100-0983S	18-20-22	MRAC, TMRAC, XAC, TXAC	.052	.078	.062	3 Piece Crimp	19	13	107-0945	107-0903-2A	107-0918	5431-14				107-0961	107-0966	5431-14
100-51020S	100-0984S	20-22-24	MRAC, TMRAC, XAC, TXAC	.045	.067	.062	3 Piece Crimp	19	13	107-0945	107-0903-2A	107-0918	5431-15				107-0961	107-0965	5431-15

Continued on page RP / 86

Winchester/Retcon

400 Park Road ■ Watertown, Connecticut 06795-0500 ■ Phone: (860) 945-5000 ■ FAX: (860) 945-5191 ■ Internet: <http://www.litton-wed.com>

100 SERIES CONTACTS																			
Loose Contact Part Number	Reeled Contact Part Number 2,000/Reel	Accommodates Conductor Sizes	Used In Connector Series	Diameter (See Drawings)		Mating Pin Diameter	Description of Contacts	See Figure Number	AMPS per Cont	For Loose Contacts				For Loose Contacts			For Reeled Contacts		
				A	B					Locator	Hand Tool	Pneumatic Tool	Gage Plug Part Number	Hand Tool Part Number	Positioner Part Number	Gage Plug Part Number	Pneumatic Tool Part Number	Depth Block Part Number	Gage Plug Part Number
100-51022S	100-0985S	22-24-26	MRAC, TMRAC, XAC, TXAC	.033	.055	.062	3 Piece Crimp	19	13	107-0945	107-0903-2A	107-0918	5431-15				107-0961	107-0965	5431-15
100-51024S	100-0986S	24-26-28	MRAC, TMRAC, XAC, TXAC	.027	.055	.062	3 Piece Crimp	19	13	107-0945	107-0903-2A	107-0918	5431-15				107-0961	107-0965	5431-15
100-51026S	100-0987S	26-28-30	MRAC, TMRAC, XAC, TXAC	.024	.050	.062	3 Piece Crimp	19	13	107-0945	107-0903-2A	107-0918	5431-15				107-0961	107-0965	5431-15
100-54020S	100-0804S	20-22	SREC, 42 Series	See Drawing		.030	3 Piece Crimp	20	5	107-43302	107-43300		5431-25						
100-54024S	100-0823S	24-26	SREC, 42 Series	See Drawing		.030	3 Piece Crimp	21	5	107-43302	107-43300		5431-25						
100-54028S	Not Available	28-30	SREC, 42 Series	See Drawing		.030	3 Piece Crimp	22	5	107-43302	107-43300		5431-25						
											Inner Contact			Outer Contact					
100-8000P	Not Available	RG178, 196/U	MRAC, TMRAC, XAC, TXAC	See Drawing		.078	Shielded Crimp	31	—	107-43303	107-43300		5431-26	107-0903-2A	107-0944				
100-8000S	Not Available	RG178, 196/U	MRAC, TMRAC, XAC, TXAC	See Drawing		.078	Shielded Crimp	32	—	107-43303	107-43300		5431-26	107-0903-2A	107-0944				
100-8001P	Not Available	RG161,179 187/U	MRAC, TMRAC, XAC, TXAC	See Drawing		.078	Shielded Crimp	31	—	107-43303	107-43300		5431-26	107-43330	Not Required				
100-8001S	Not Available	RG161,179 187/U	MRAC, TMRAC, XAC, TXAC	See Drawing		.078	Shielded Crimp	32	—	107-43303	107-43300		5431-26	107-43330	Not Required				
100-8003P	Not Available	RG174,188 316/U	MRAC, TMRAC, XAC, TXAC	See Drawing		.078	Shielded Crimp	31	—	107-43303	107-43300		5431-26	107-43330	Not Required				
100-8003S	Not Available	RG174,188 316/U	MRAC, TMRAC, XAC, TXAC	See Drawing		.078	Shielded Crimp	32	—	107-43303	107-43300		5431-26	107-43330	Not Required				
7130	Not Available	Dip Solder	MRAC, TMRAC	Not Applicable		.062	Dip Solder	9	13	N/A Dip Solder									
7131	Not Available	Dip Solder	MRAC, TMRAC	Not Applicable		.062	Dip Solder	10	13	N/A Dip Solder									
8122	Not Available	Wire Wrap	SREC	Not Applicable		.030	Wire Wrap	13	5	N/A Wire Wrap									
8123	Not Available	Wire Wrap	SREC	Not Applicable		.030	Wire Wrap	14	5	N/A Wire Wrap									
8124	Not Available	Dip Solder	MRAC, TMRAC	Not Applicable		.062	Dip Solder	11	5	N/A Dip Solder									
8125	Not Available	Dip Solder	MRAC, TMRAC	Not Applicable		.062	Dip Solder	12	13	N/A Dip Solder									
8113	Not Available	Wire Wrap	MRAC, TMRAC	Not Applicable		.062	Wire Wrap	16	13	N/A Wire Wrap									
8114	Not Available	Wire Wrap	MRAC, TMRAC	Not Applicable		.062	Wire Wrap	15	13	N/A Wire Wrap									
8105	Not Available	Wire Wrap	MRAC, TMRAC	Not Applicable		.062	Wire Wrap	18	13	N/A Wire Wrap									
8106	Not Available	Wire Wrap	MRAC, TMRAC	Not Applicable		.062	Wire Wrap	17	13	N/A Wire Wrap									

100-S = Military Contacts

Continued on page RP / 87

MIL-C-39029 CONTACTS

M39029 Part Number	Winchester Part Number	Accommodates Conductor Sizes	Used In Connector Series	Diameter		Mating Pin Dia.	Description of Contacts	See Figure Number	AMPS per Cont	MIL Spec Crimp Tool	Winchester Crimp Tool	MIL Spec Positioner	Winchester Positioner	Insertion Tool MIL	Insertion Tool Winchester	Removal Tool MIL	Removal Tool Winchester
				A	B												
M39029/34-271	100R-2020P95	20-22-24	M28748	.045	.067	.040	Crimp Contact	3	7.5	M22520/1-01	107-0903-2A	M22520/1-03	107-0945	M81969/18-01	107-1015	M81969/20-01	107R1001
M39029/34-272	100R-1020P95	20-22-24	M28748	.045	.067	.062	Crimp Contact	1	13	M22520/1-01	107-0903-2A	M22520/1-03	107-0945	M81969/18-01	107-1015	M81969/20-01	107R1001
M39029/34-273	100B-1016P95	16-18-20	M28748	.067	.092	.062	Crimp Contact	1	13	M22520/1-01	107-0903-2A	M22520/1-03	107-0945	M81969/18-01	107-1015	M81969/20-01	107R1001
M39029/34-440	100-202861-50	22-24-26	M28748	.035	.056	.030	Crimp Contact	29	5	M22520/2-01	107-43300	Buchn.614412	107-0611	M81969/18-02	IT2857	M81969/20-02	RT2855
M39029/35-274	100R-2020S95	20-22-24	M28748	.045	.067	.040	Crimp Contact	4	7.5	M22520/1-01	107-0903-2A	M22520/1-03	107-0945	M81969/18-01	107-1015	M81969/20-01	107R1001
M39029/35-275	100R-51020S95	20-22-24	M28748	.045	.067	.062	Crimp Contact	19	13	M22520/1-01	107-0903-2A	M22520/1-03	107-0945	M81969/18-01	107-1015	M81969/20-01	107R1001
M39029/35-276	100B-51016S95	16-18-20	M28748	.067	.092	.062	Crimp Contact	19	13	M22520/1-01	107-0903-2A	M22520/1-03	107-0945	M81969/18-01	107-1015	M81969/20-01	107R1001
M39029/35-441	100-202862-50	22-24-26	M28748	.035	.056	.030	Crimp Contact	30	5	M22520/2-01	107-43300	Buchn.614412		M81969/18-02	IT2857	M81969/20-02	RT2855

Rack & Panel

100 Series

Removable Contacts

OUTLINE

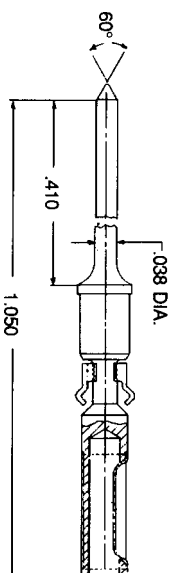
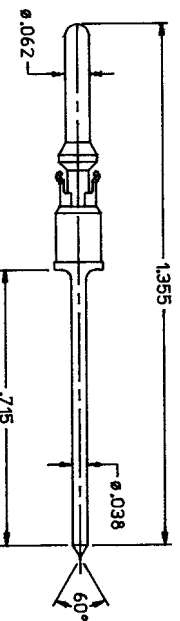
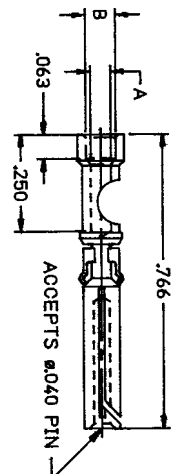
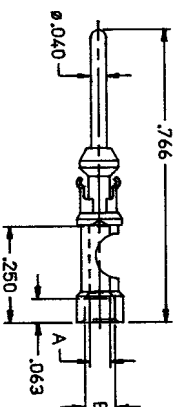
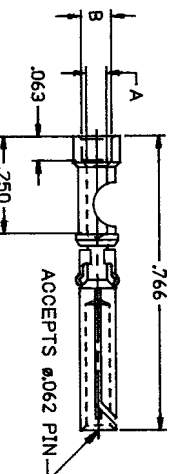
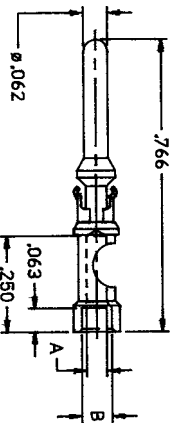
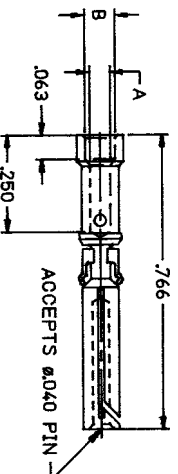
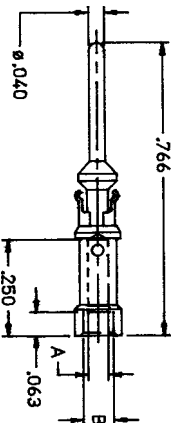
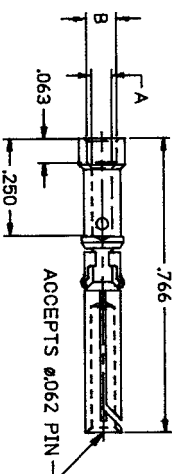
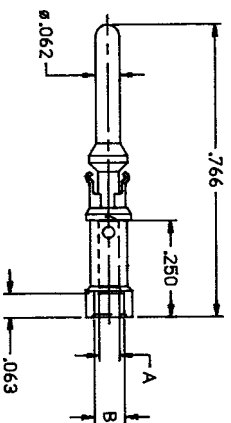

Winchester/Retconn

400 Park Road ■ Watertown, Connecticut 06795-0500 ■ Phone: (860) 945-5000 ■ FAX: (860) 945-5191 ■ Internet: <http://www.litton-wed.com>

RP / 88

Rack & Panel

100 Series

Removable Contacts

OUTLINE

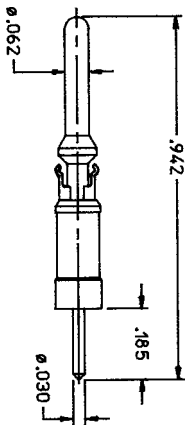

Figure 11

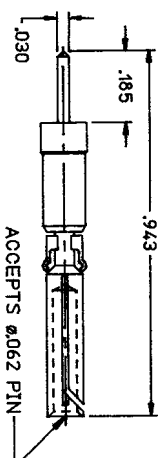

Figure 12

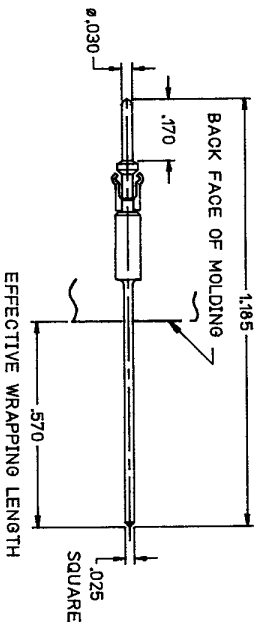

Figure 13

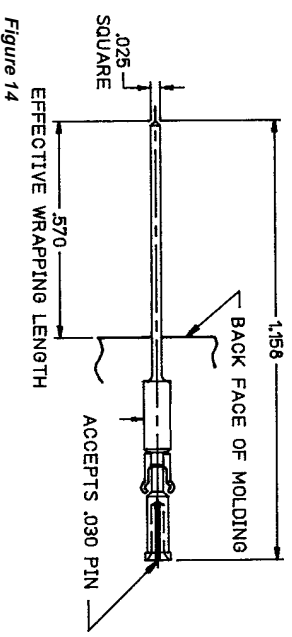

Figure 14

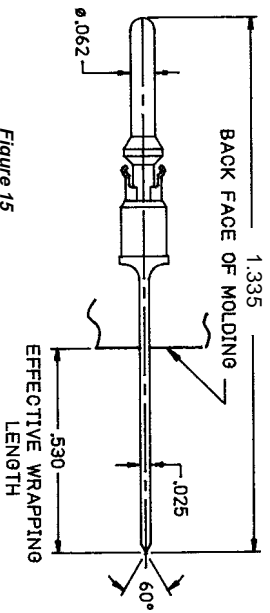

Figure 15

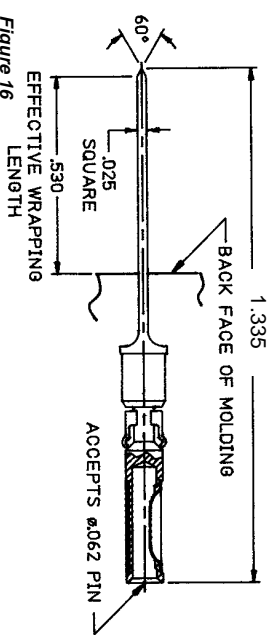

Figure 16

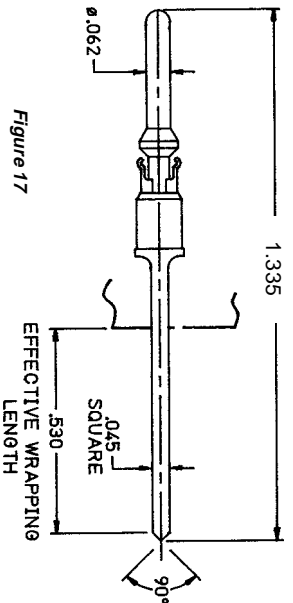

Figure 17

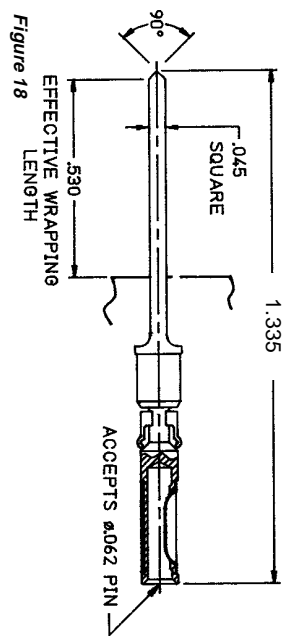

Figure 18

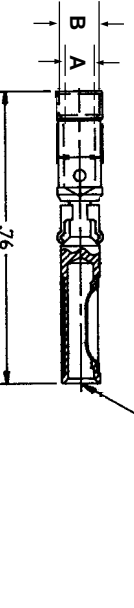

Figure 19

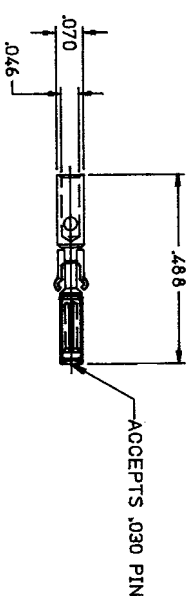

Figure 20

Winchester/Retconn

400 Park Road ■ Watertown, Connecticut 06795-0500 ■ Phone: (860) 945-5000 ■ FAX: (860) 945-5191 ■ Internet: <http://www.litton-wed.com>

Rack & Panel

100 Series

Removable Contacts

OUTLINE

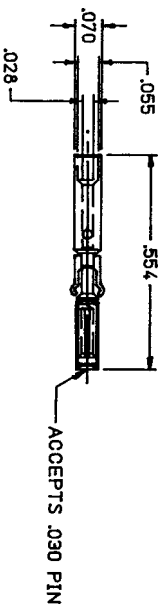

Figure 21

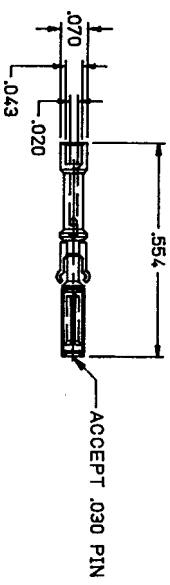

Figure 22

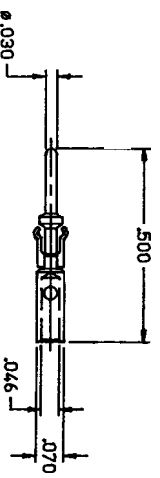

Figure 23

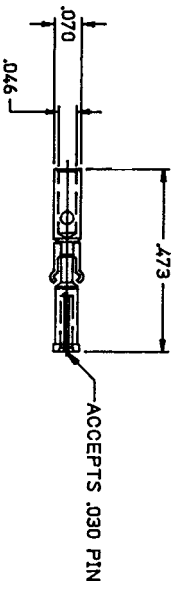

Figure 24

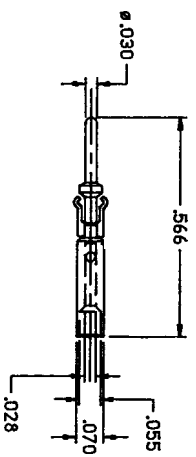

Figure 25

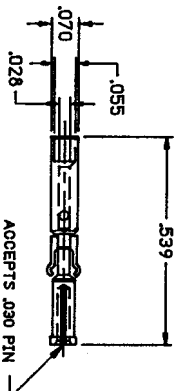

Figure 26

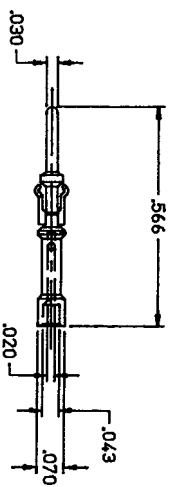

Figure 27

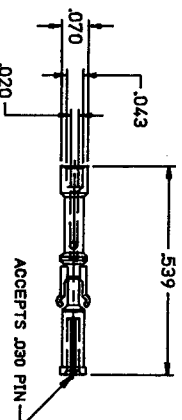

Figure 28

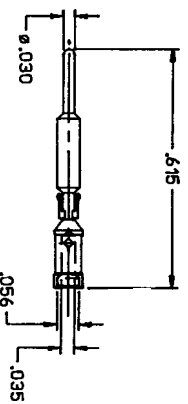

Figure 29

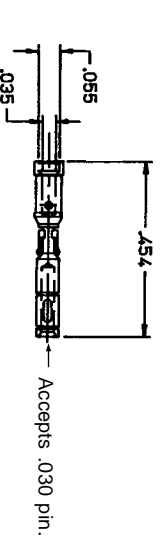

Figure 30

Winchester/Retconn

400 Park Road ■ Watertown, Connecticut 06795-0500 ■ Phone: (860) 945-5000 ■ FAX: (860) 945-5191 ■ Internet: <http://www.litton-wed.com>

RP / 90

Rack & Panel

100 Series

Removable Contacts

OUTLINE

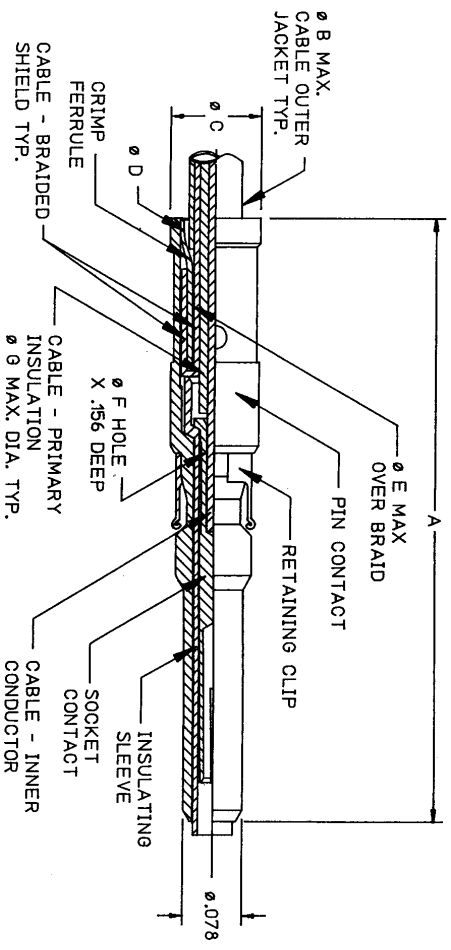

Figure 31

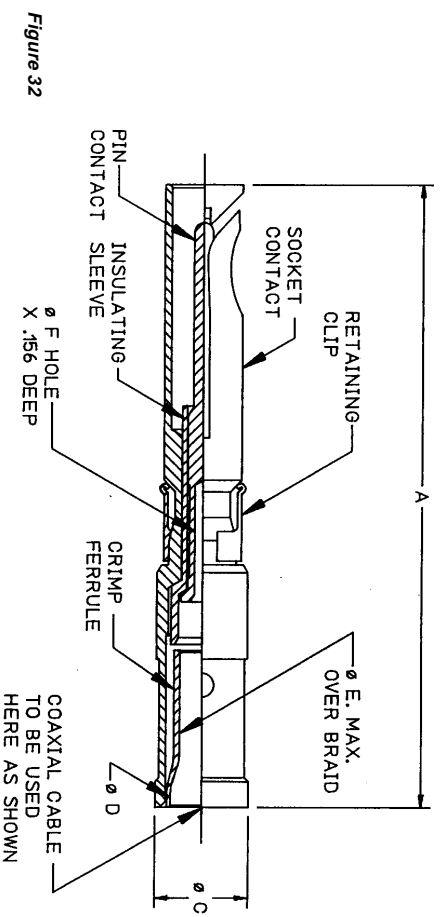

Figure 32

ORDERING INFORMATION

Catalog Number	Style	Cable Sizes	Dimensions						
			A	B	C	D	E	F	G
100-8000P	Pin	RG178/U RG196/U	.797	.080	.120	.082	.057	.020	.036
100-8000S	Socket								
100-8001P	Pin	RG161/U RG179/U RG187/U	1.031	.110	.137	.111	.082	.020	.063
100-8001S	Socket								
100-8003P	Pin	RG174/U RG188/U RG316/U	1.031	.110	.137	.111	.082	.023	.063
100-8003S	Socket								

Winchester/Retconn

400 Park Road ■ Watertown, Connecticut 06795-0500 ■ Phone: (860) 945-5000 ■ FAX: (860) 945-5191 ■ Internet: <http://www.litton-wed.com>